

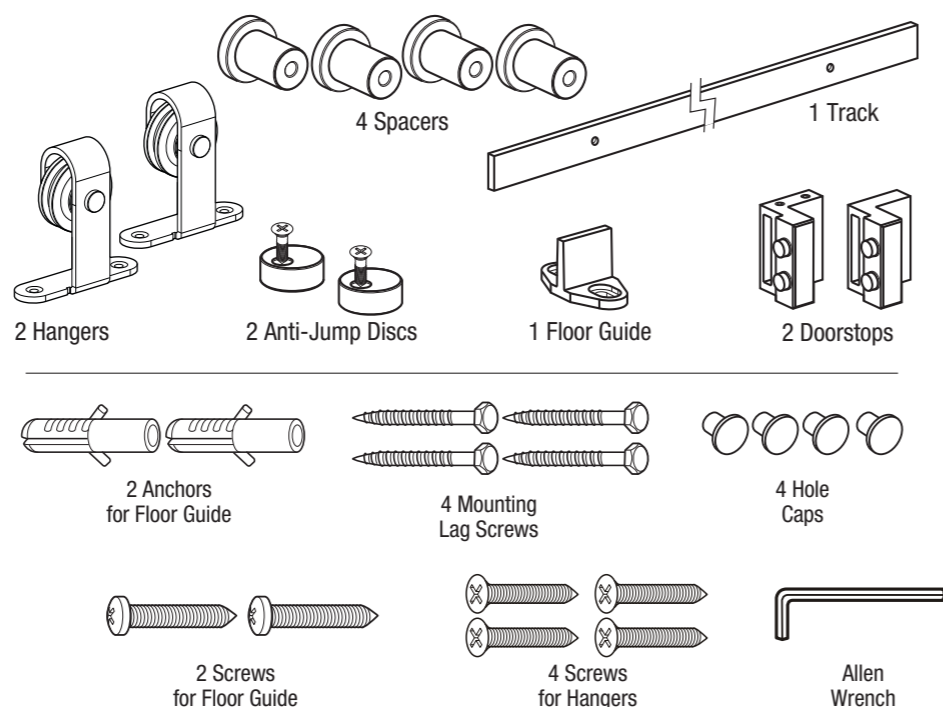

DECORATIVE BARN DOOR HARDWARE INSTALLATION INSTRUCTIONS

1001 808 901

Barn Door Track Hardware Kit Includes:



1 Preparing Wall

Decorative Barn Door Track must be installed into a solid blocking or extended head casing.
WARNING: Do NOT install Flat Track Hardware solely on drywall or other wallboard surface as these surfaces may not support the track. Every track mounting screw used in the installation process needs to be securely fastened into a structural surface.

A. If you do not have drywall yet, add wooden blocking across the studs. Typical solid blocking needs to be 1 in x 4 in and the same length as the track.

B. If the wall is complete and has drywall, use a mounting board to add support for heavy doors. Use interior screws (not included) to secure the board to wall studs.

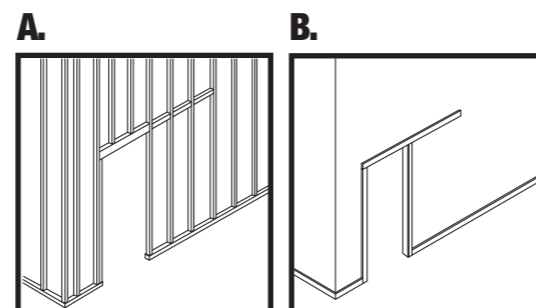

2 Installing Track

To install the track, measure up from the finished floor "door height + 1-7/8 in" to the center of the track. Leave a minimum of 2 in from the end of the track to the side of the door opening and use a level to level the track. Once the track has been leveled, mark screw holes and predrill 1/4 in pilot holes. Align spacers behind the track. Install flat washer on the lag bolt and attach track to the board or wall.

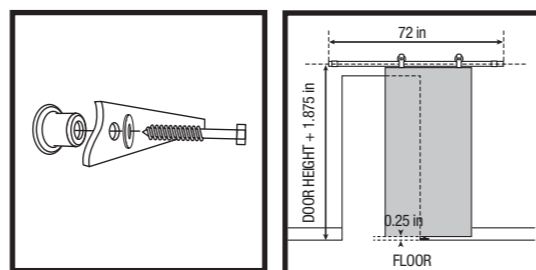

3 Preparing Door

Mortise 1/4 in wide by 3/4 in deep continuous groove in the bottom of door for Floor Guide. This will prevent door from swinging in and out.

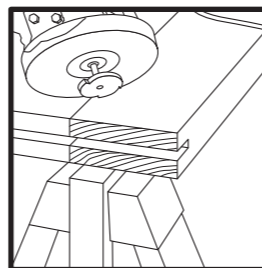

4 Installing Hangers

Position hanger on top of door so it is parallel to the edge of the door, leaving at least 2 in between the edge of the door and the edge of the hanger. Mark hanger screw locations. Repeat process for the second hanger. Using a 3/8 in drill bit, drill through holes on the door. For 1-3/8 in doors use 2-5/32 in bolts and for 1-3/4 in doors use 2-1/2 in bolts to mount hangers as shown.

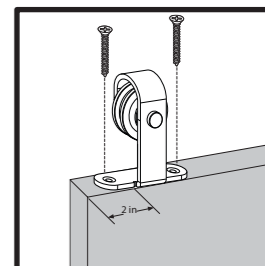

5 Installing Anti-Jump Discs

Fasten anti-jump discs to top of door by placing them at least 1 in. from the edge of door.

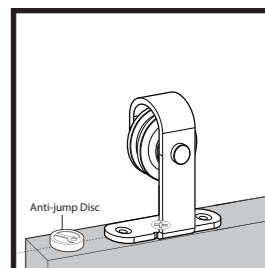

6 Placing Door on a Track

Place assembled door with hangers onto track. Use a level to plumb the door. Make sure all parts work properly by sliding door back and forth.

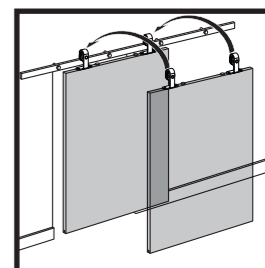

7 Installing Door Stops and Floor Guide

After door is plumb, position one doorstop so door overlaps opening by 1 in. when in open position. Tighten doorstop once positioned correctly (do not tighten the second doorstop yet). Mark centerline of overlap and place center of Floor Guide in line. Slide the door closed and secure the Floor Guide. If going into a concrete floor, use provided anchors. Tighten the second doorstop. Slide door all the way to ensure proper Doorstop and Floor Guide installation.

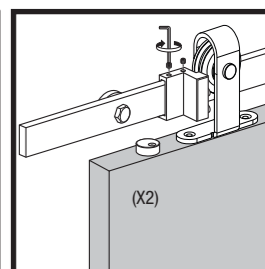
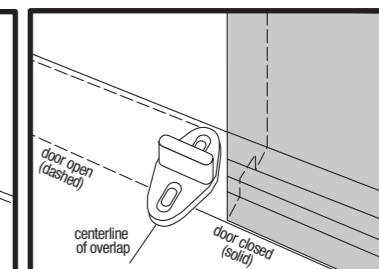
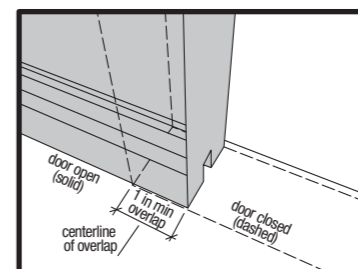

8 Hole Caps

If doorstops are positioned so that Multiple Track Connecting Adapter holes are exposed, insert hole caps.

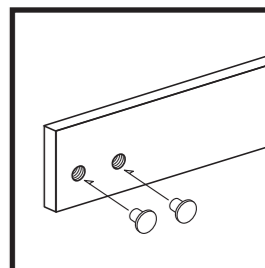

9 Connecting Multiple Tracks

If door opening is over 36 in., multiple tracks can be connected with Connecting Adapter (SKU Number 1000017091) for wider or bi-parting doors. Follow instructions on Connecting Adapter and steps 1 through 8 of above.

